

# Nylon Insulated Flanged Spade Terminal with Support Sleeve

## 2216 AWG Nylon Insulated Flanged Spade with Copper Support Sleeve

**Material:** Tin Plated Copper with Butted Seam

**Insulation Material:** Red 6/6 Nylon with Funnel Entry Copper Support Sleeve

**Maximum Electrical Current:** 18 Amps

**Maximum Electrical Rating:** 75°C, 600V

**Material Thickness:** (T) .030

**Barrel ID (d1):** .067

**Barrel OD (D):** .177     **J Type:** .157

**Barrel Length (E):** .433     **J Type:** .378

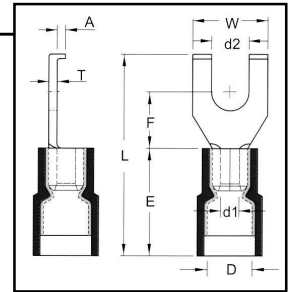

HOFFMAN PART NO.	STUD SIZE	DIMENSIONS (INCHES)					UL	TAPE MOUNTED REEL QTY	DIE FOR TAPE MOUNTED	HAND TOOL
		STUD DIAMETER	TONGUE WIDTH	STUD CLEARANCE	LENGTH	FLANGE HEIGHT				
		d2	W	F	L	A				
FND2216S3B	6	0.146	0.295	0.201	0.787	0.059	Y	1000	3V2216	YNM2210D
FND2216S3B/J	6	0.146	0.295	0.201	0.705	0.059	Y	1000	3V2216	YNT2216
FND2216S4B	8	0.169	0.295	0.201	0.787	0.059	Y	1000	3V2216	YNM2210D
FND2216S4B/J	8	0.169	0.295	0.201	0.705	0.059	Y	1000	3V2216	YNT2216
FND2216S5B	10	0.209	0.295	0.201	0.787	0.059	Y	1000	3V2216	YNM2210D
FND2216S5B/J	10	0.209	0.295	0.201	0.705	0.059	Y	1000	3V2216	YNT2216

## 1614 AWG Nylon Insulated Flanged Spade with Copper Support Sleeve

**Material:** Tin Plated Copper with Butted Seam

**Insulation Material:** Blue 6/6 Nylon with Funnel Entry Copper Support Sleeve

**Maximum Electrical Current:** 30 Amps

**Maximum Electrical Rating:** 75°C, 600V

**Material Thickness (T):** .031

**Barrel ID (d1):** .091

**Barrel OD (D):** .205     **J Type:** .185

**Barrel Length (E):** .433     **J Type:** .378

HOFFMAN PART NO.	STUD SIZE	DIMENSIONS (INCHES)					UL	TAPE MOUNTED REEL QTY	DIE FOR TAPE MOUNTED	HAND TOOL
		STUD DIAMETER	TONGUE WIDTH	STUD CLEARANCE	LENGTH	FLANGE HEIGHT				
		d2	W	F	L	A				
FND1614S3B	6	0.146	0.295	0.205	0.807	0.059	Y	1000	3V1614	YNM2210D
FND1614S3B/J	6	0.146	0.295	0.201	0.705	0.059	Y	1000	3V2216	YNT2216
FND1614S4B/J	8	0.169	0.295	0.201	0.705	0.059	Y	1000	3V2216	YNT2216
FND1614S4B	8	0.169	0.295	0.205	0.807	0.059	Y	1000	3V1614	YNM2210D
FND1614S5B	10	0.209	0.295	0.205	0.807	0.059	Y	1000	3V1614	YNM2210D
FND1614S5B/J	10	0.209	0.295	0.201	0.705	0.059	Y	1000	3V2216	YNT2216

